

PLAN

16' min. (Typ.)

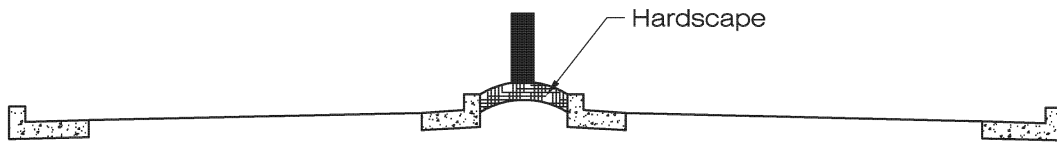

PROFILE

NOTE:

1. Sign cannot impair sight distance.
2. The sign (in Fort Collins) must meet the following criteria:
 - sign must have a max height of 5'.
 - sign surface area must be 24 square feet (max.)
 - The word "neighborhood" must be included in the signage lettering.

NEIGHBORHOOD IDENTIFICATION ISLAND

**LARIMER COUNTY
URBAN AREA
STREET STANDARDS**

**DESIGN
FIGURE**

REVISION NO:

DATE: 08/07/00

FIGURE

18-5

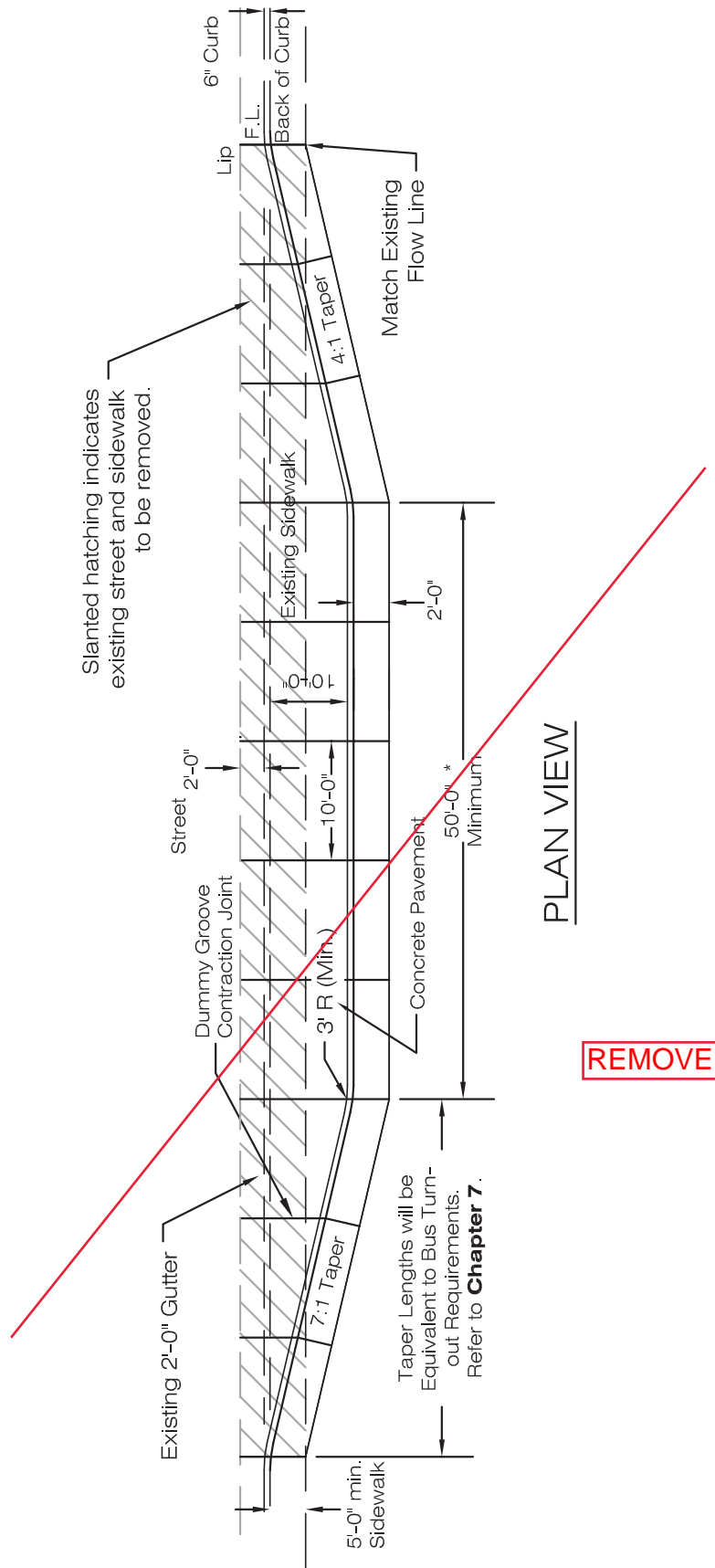

DROP OFF ZONE FOR SCHOOL

LARIMER COUNTY
 URBAN AREA
 STREET STANDARDS

DESIGN
 FIGURE

REVISION NO: 1
 DATE: 04/01/07

FIGURE
 18-6

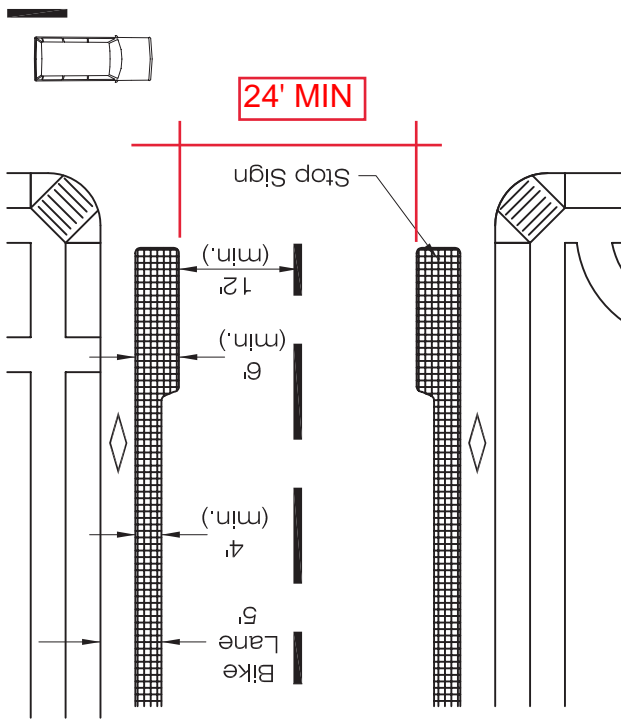
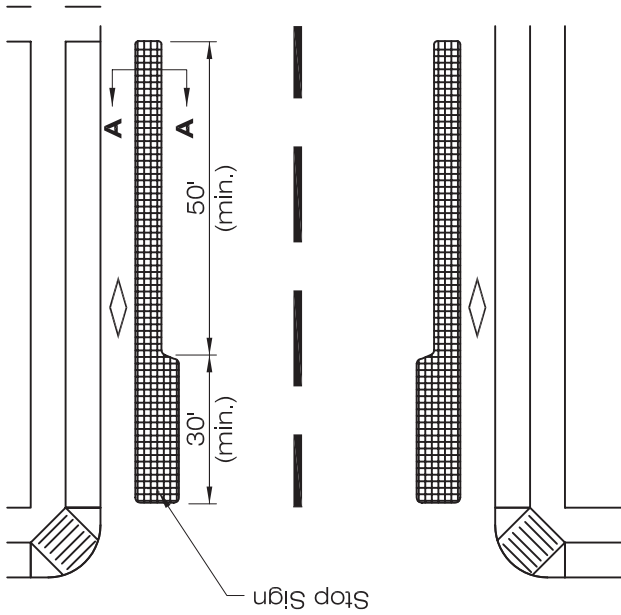

PLAN

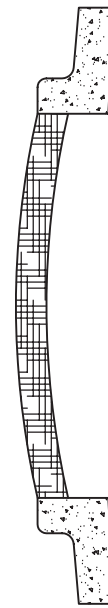

INTERSECTION CHOKER

LARIMER COUNTY
URBAN AREA
STREET STANDARDS

DESIGN
FIGURE

REVISION NO:

DATE: 08/07/00

FIGURE

18-7

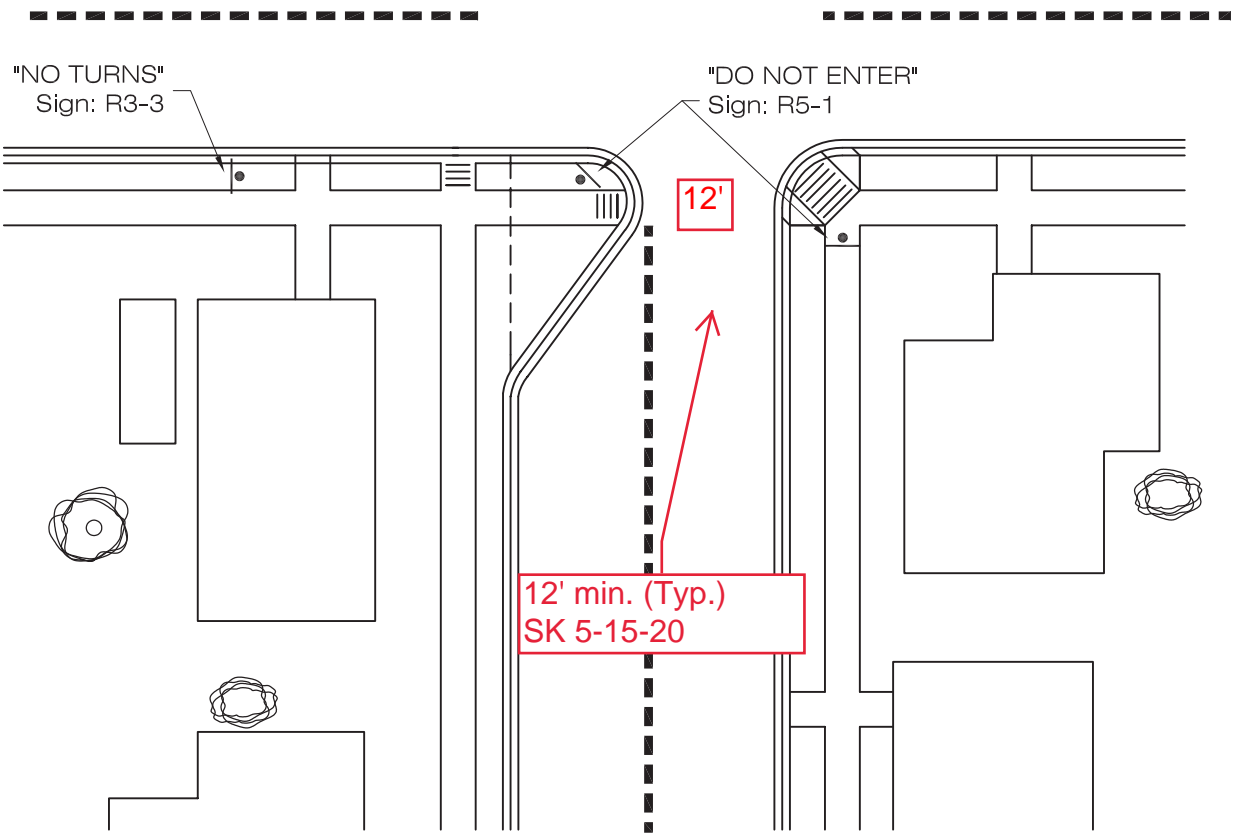
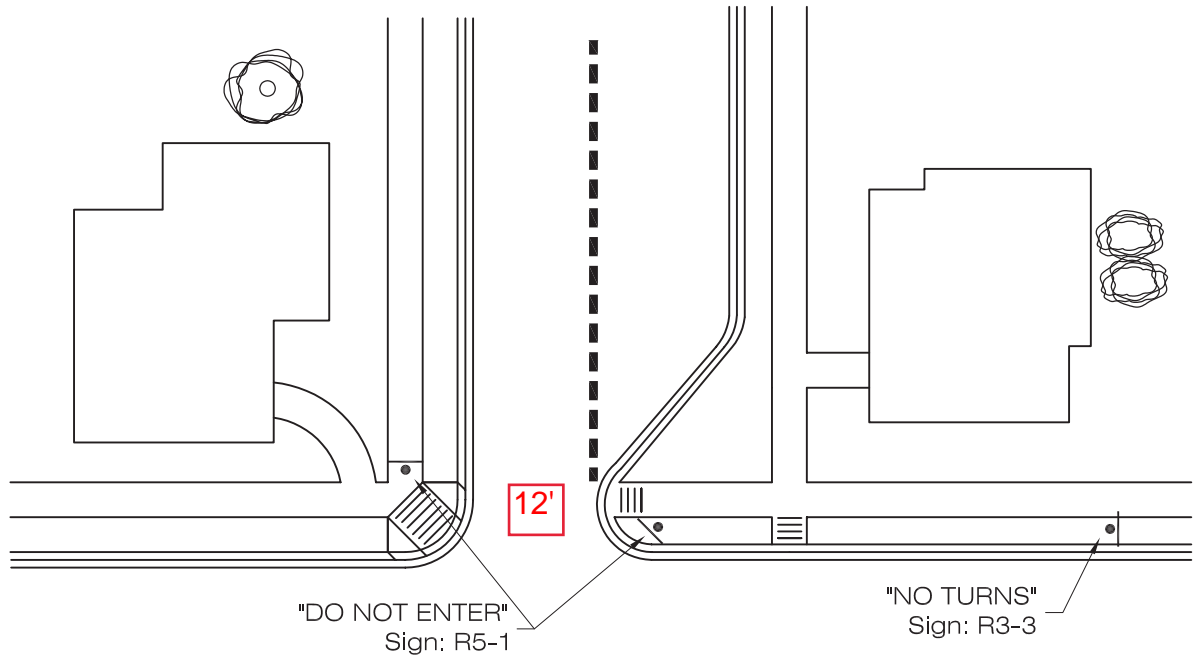

NOTE:
1. Any landscaping provided must be maintained by HOA, City Forester or private owner; otherwise, area must be hardscaped.

SEMI-DIVERTERS

LARIMER COUNTY URBAN AREA STREET STANDARDS	DESIGN FIGURE	REVISION NO:	FIGURE 18-9
		DATE: 08/07/00	

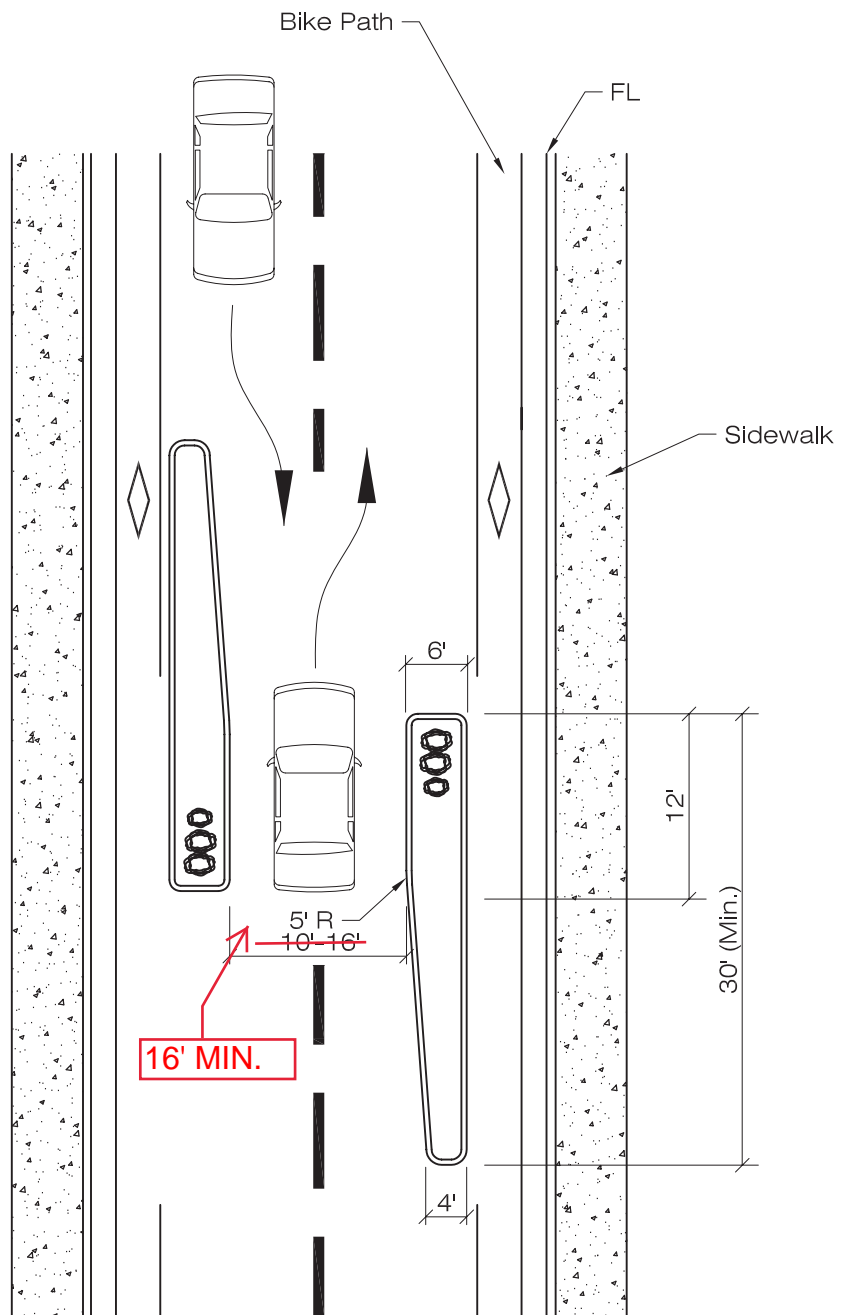

NOTE:

1. 2 lanes narrow to 1 lane. Cars must queue and take turns to travel through single lane.

LANE ELIMINATING CHOKER

LARIMER COUNTY
URBAN AREA
STREET STANDARDS

DESIGN
FIGURE

REVISION NO:

DATE: 08/07/00

FIGURE

18-10