

SIGHT DISTANCE AT INTERSECTIONS AND ACCESSES FOR SIGN INSTALLATION

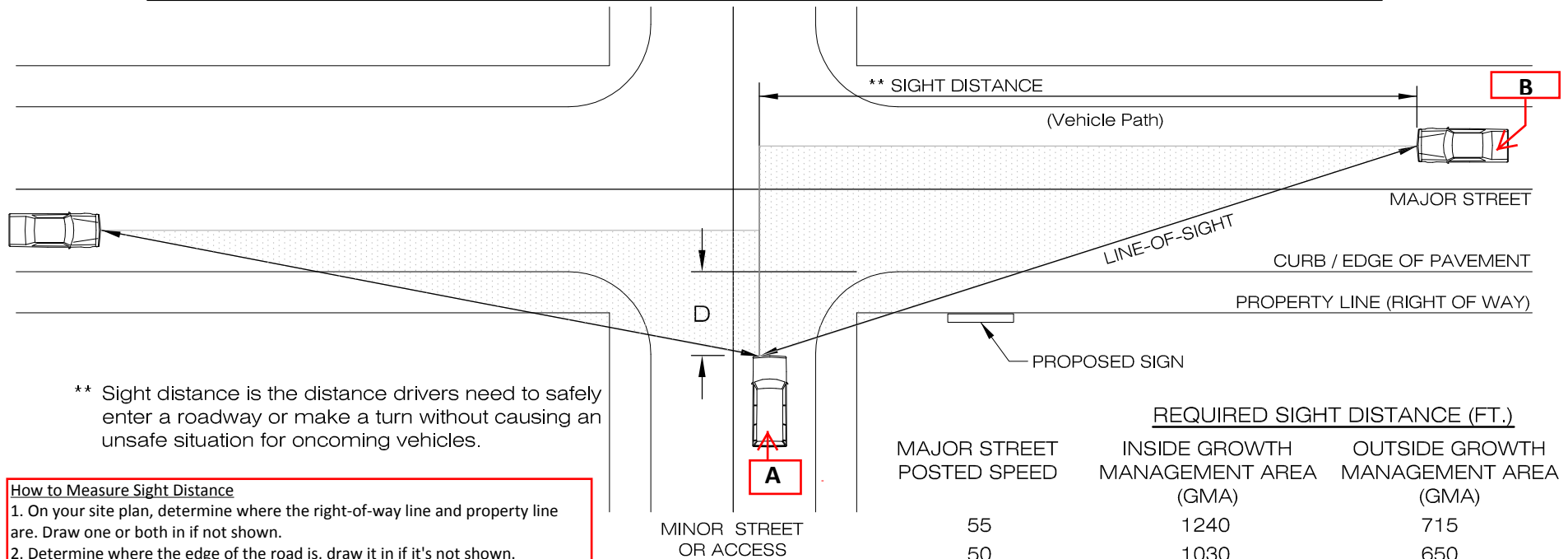

** Sight distance is the distance drivers need to safely enter a roadway or make a turn without causing an unsafe situation for oncoming vehicles.

How to Measure Sight Distance

1. On your site plan, determine where the right-of-way line and property line are. Draw one or both in if not shown.
2. Determine where the edge of the road is, draw it in if it's not shown.
3. Determine distance "D" as shown in the diagram, either 10 or 13 feet from the edge of the road (see notes 3 & 4).
4. Determine "Sight Distance" based on the chart to the right and the speed of the Major Street.
5. On your plan, draw the "Line of Sight" between the entering vehicle (A) and the approaching vehicle (B) as shown on the diagram. These measurements create the "Sight Triangle."
6. The location of your sign should be outside of the sight triangle and the right-of-way line. Change the location of the sign as needed.

MAJOR STREET POSTED SPEED	REQUIRED SIGHT DISTANCE (FT.)	
	INSIDE GROWTH MANAGEMENT AREA (GMA)	OUTSIDE GROWTH MANAGEMENT AREA (GMA)
55	1240	715
50	1030	650
45	830	585
40	660	520
35	520	455
30	310	390
25	260	325
20	210	---

- NOTES:
1. The sign must be outside of the road right-of-way (or easement) AND outside of the sight triangle line (aka - Line-of-Sight).
 2. Sight distance is measured from a height of eye at 3.50 feet on the minor road to a height of object at 4.25 feet on the major road.
 3. Inside the Growth Management Area, distance "D"=10.0 feet if entering onto a local road. Distance "D"=13.0 feet in all other cases (such as entering onto a collector or arterial).
 4. Outside the Growth Management Area distance "D"=10.0 feet in all cases.
 5. Contact the Larimer County Engineering department (970-498-5700) for additional guidance if:
 - The major street is on a noticeable slope or hill.
 - Multi-unit trucks will use the access on a regular basis.
 - The major street is a multi-lane roadway (values shown here only apply to 2 lane roads).
 - Intersection is skewed
 - Additional information is needed other than what is specified on this sheet.